

Bramante in Cali 69 Going Up? The Elevator Experts 32
2010 Market Forecast 19 More Cupcakes 57

ARCHITECT

hanley wood

THE EDUCATION ISSUE
2009 ARCHITECTURE SCHOOL GUIDE



CONTENT



BILL TIMMERMAN



IAN ALLEN

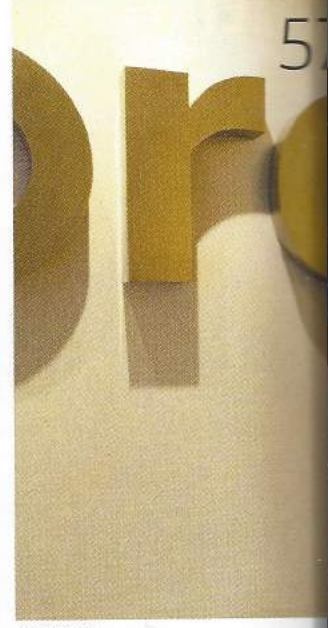

ANDY TINUCCI

FEATURES

44

Arch Ed 2009

ARCHITECT launches a new guide to inform (and demystify) the process of choosing an architecture school. EDITED BY AMANDA KOLSON HURLEY

- Listings for 24 architecture schools (visit architectmagazine.com for additional school listings). AMANDA KOLSON HURLEY
- The resurgence of design/build. STEVE BADANES
- How to choose the right school for you. TED LANDSMARK
- Profiles of Rensselaer student Rachele Louis and Cincinnati professor Anton Harfmann. EDWARD KEEGAN
- A look inside a Georgia Tech graduate studio and at USC's Master of Building Science program. AMANDA KOLSON HURLEY
- And more ...

BUILDINGS

57

More Cupcakes

The design by David Woodhouse Architects positions a Chicago-area cupcake store to look like the Tiffany & Co. of bakeries. KATIE GERFEN

61

Henkel Headquarters

Henkel's U.S. corporate headquarters, designed by Will Bruder+Partners and CH2M Hill, rises from the desert on the northern edge of Scottsdale, Ariz. MIMI ZEIGER

69

Our Lady of the Most Holy Trinity

The leaders of Thomas Aquinas College wanted their new chapel to distill Western religious architectural traditions in a single building—and they called on Duncan Stroik to deliver. BRADFORD MCKEE

"[EVEN] IF YOU'RE AN ATHEIST, WHEN YOU GO INTO IT, YOU FEEL REVERENT."

PETER DELUCA, interim president of Thomas Aquinas College, about the chapel designed by Duncan Stroik in "Our Lady of the Most Holy Trinity," page 69.

ON THE COVER
A STUDENT IN ONE OF THE GEORGIA TECH GRADUATE STUDIOS HARD AT WORK.
PHOTO BY IAN ALLEN.



TEXT BY MIMI ZEIGER
PHOTOS BY BILL TIMMERMAN

The Henkel Headquarters building in Scottsdale, Ariz., brings site-sensitive architecture to the edge of the Sonoran Desert. The flagship project in an as-yet-incomplete, mixed-use development is under consideration for LEED Silver certification.

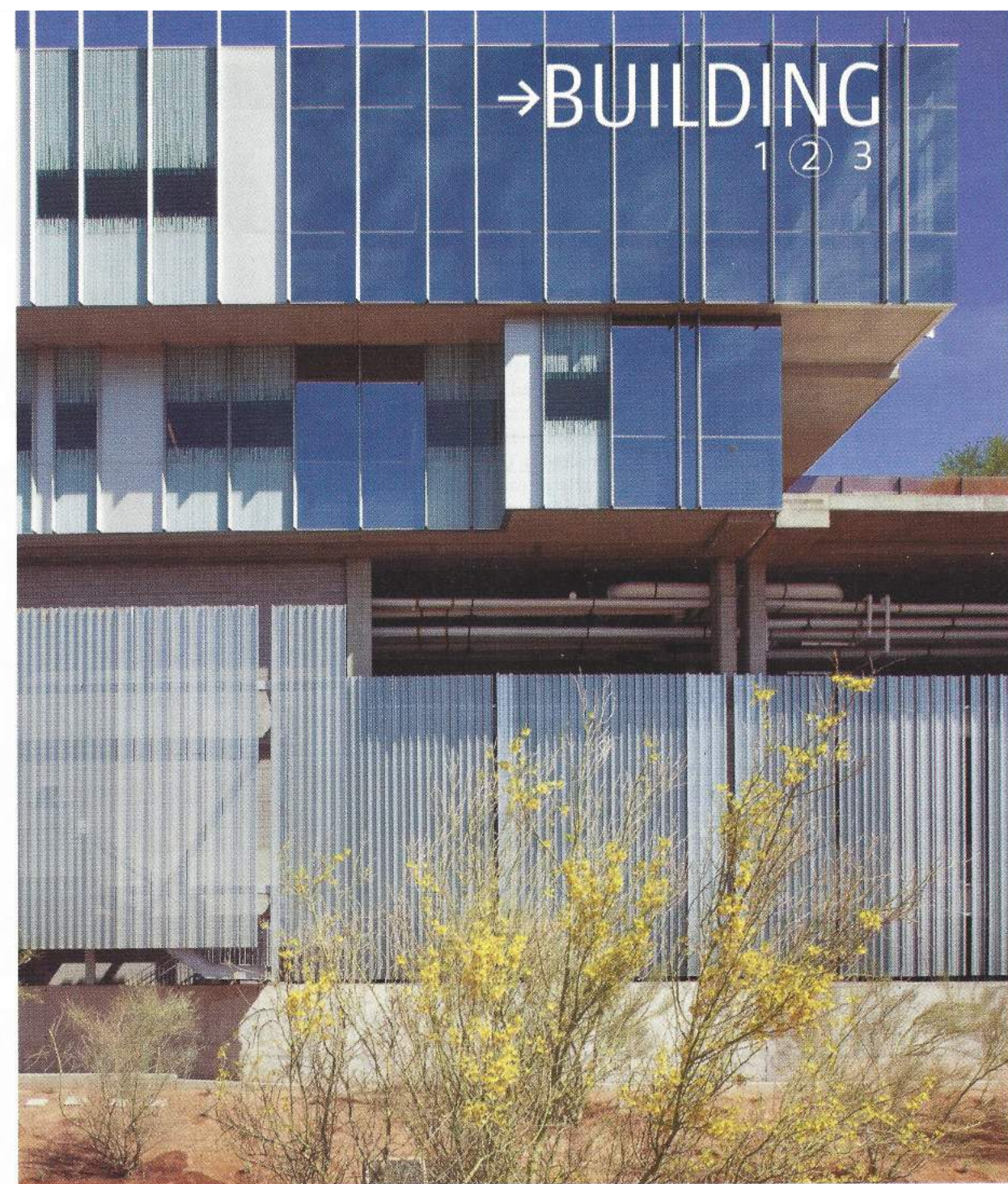

HENKEL HEADQUARTERS

SCOTTSDALE, ARIZ.
WILL BRUDER+PARTNERS, CH2M HILL

HENKEL'S U.S. CORPORATE HEADQUARTERS sits on the northernmost edge of sprawling Scottsdale, Ariz., on a site bracketed by the State Route 101 and 120 acres of ripped-up ground awaiting construction. Where the grading machines stopped, the Sonoran Desert stretches out to the foothills of the McDowell Mountains. Phoenix-based architect Will Bruder with CH2M Hill designed the four-story office and laboratory building to be a signature cornerstone for One Scottsdale, a ritzy planned mixed-use development with retail, residential, office, and entertainment. Right now, with construction of the overall project stalled until potentially 2014, Henkel's headquarters building is a flagship moored on the banks of what Bruder refers to as a "Michael Heizer earthwork."

Despite its marooning, the structure fits comfortably in its context. Stands of mesquite and ironwood trees and saguaro cactuses were salvaged from the rest of the One Scottsdale site and replanted around the building. "[The building] almost looks like it grows from the desert," Bruder says. "The landscape acts as a buffer between the freeway and the façade."

Commuters see that 200-foot-long façade from the roadway at 65 mph; it goes by in a 7.5-second streak of fritted glass and aluminum mullions. The opposite side, designed to front the streets of the forthcoming development, takes a slower pace. Attention is given to texture: Terra-cotta bricks and gray Mexican plaster contrast with the sleek curtain wall, which masks interior offices, labs, and a "cafetorium." Folds and bends in the façade allow for a covered port-cochere and accommodate access to below-grade parking. At the front entry, fiberglass column covers glow in the desert light with a brightness that matches an array of red, green, and amber neon signs advertising the Henkel brands.

Typical of suburban office employees, Henkel's begin their day in the 900-car parking garage. Bruder used graphics and both artificial and natural light to turn the three subterranean floors into memorable, functional places. "We made [the parking garage] into an art piece. It's not a forgotten space," he explains. Channeling the work of artist Dan Flavin, fluorescent strip lights are wrapped in colored gels.

Life in the 348,000-square-foot headquarters centers around two key spaces: the atrium and the cafetorium, a grand room on the second floor, which, as the name implies, doubles as both cafeteria and assembly area. (It comfortably can hold the entire staff.) Bruder calls the 82-foot-high atrium a "vessel of light," as the skylit volume carries daylight into the surrounding office floors. An open stairwell floats in the space; with generous landings and a comfortable rise-to-run ratio, it's designed to give Henkel employees a spot to stop and chat.

The desert reasserts itself on the third floor in the form of a grand roof garden designed by landscape architect Christy Ten Eyck. Adjacent to the fitness center and cafetorium mezzanine, it provides nearly an acre and a half of outdoor space. Native shrubs and trees foreground a distant view of the McDowell Mountains. It's a powerful visual trick: From the elevated perspective the One Scottsdale construction site disappears, leaving only undisturbed desert.

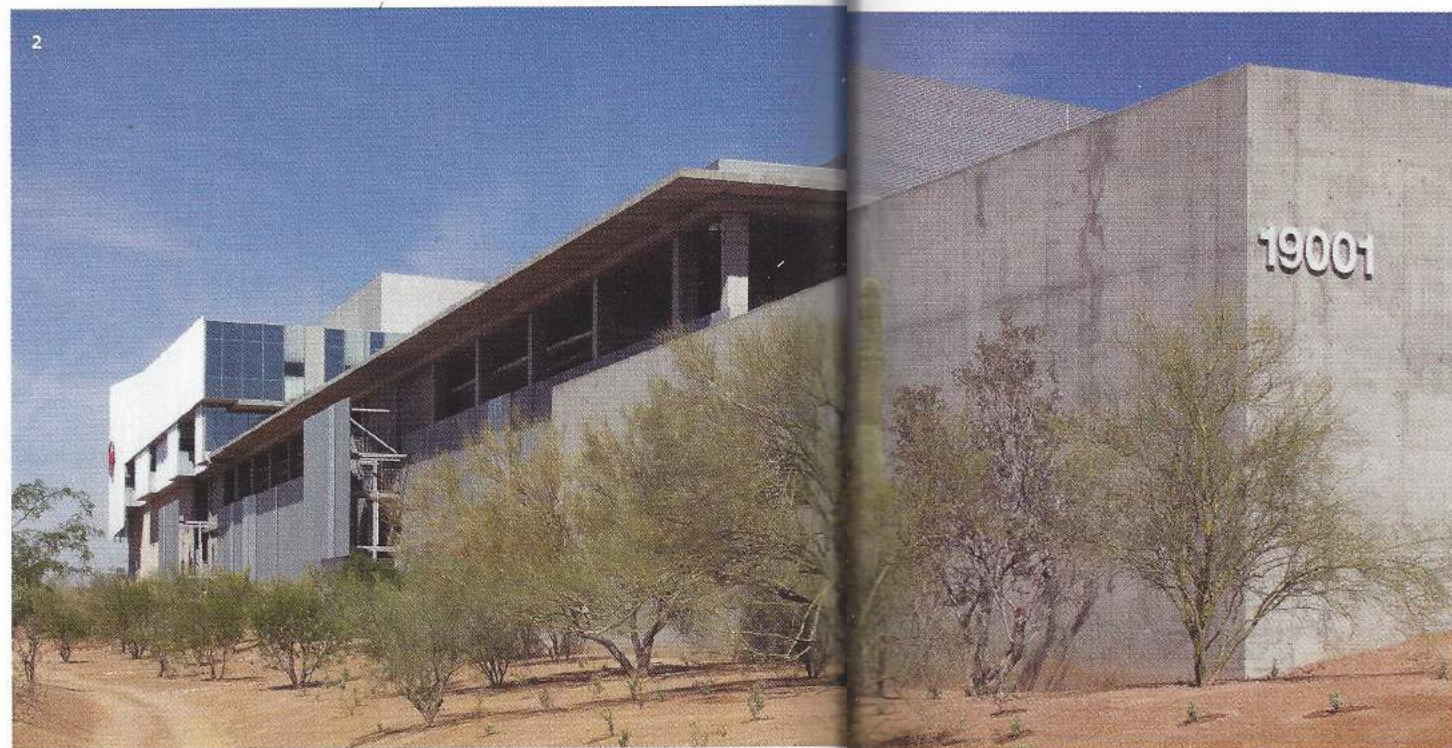

Curtain Wall Section

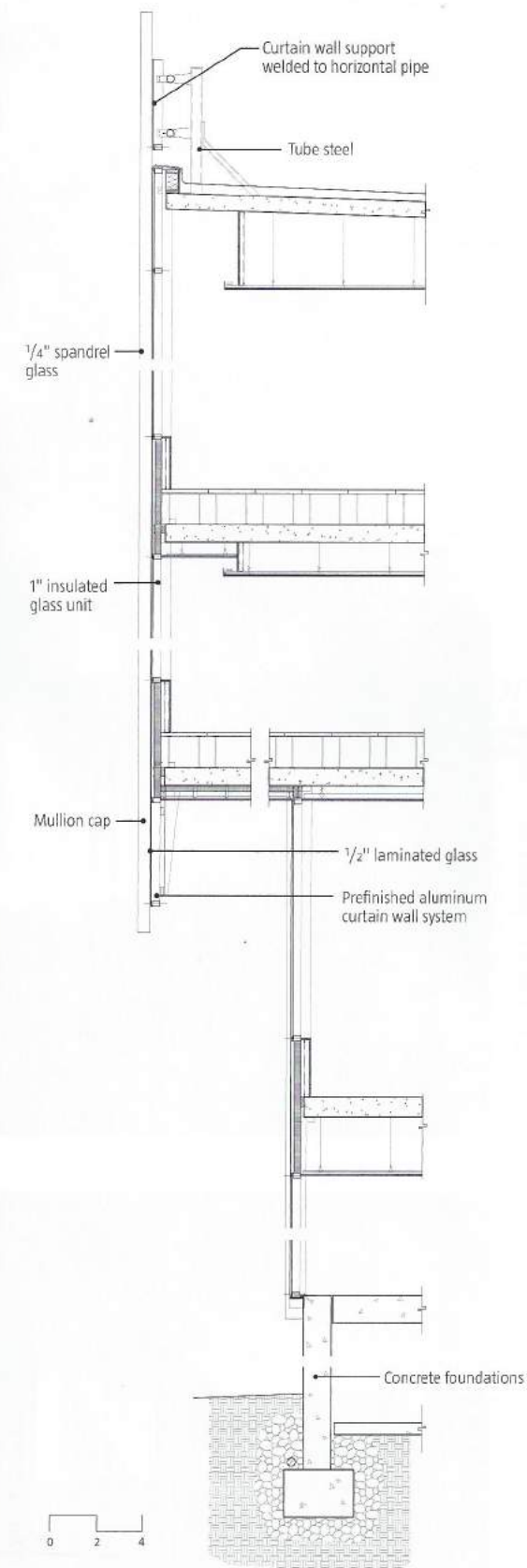

1. The façade facing the neighboring State Route 101 is a 200-foot-long ribbon of fritted glass and aluminum mullions. Used as sunshading, the custom frit patterns are carefully positioned along the façade to limit heat gain while maximizing the penetration of daylight into the space.

2. On the other side of the building, the sleek glass panels give way to gray Mexican plaster, terra-cotta, and corrugated metal. Intended to be the face of the headquarters from within the One Scottsdale development, the building is carefully massed to be broken up and less imposing in scale. For now, that massing harmonizes with the native plant species that dominate the rest of the site.

1. The glass façade extends past the northwest corner of the building, supported by a prefabricated aluminum curtain wall system and supports welded to horizontal pipe and tube steel. Mullion caps extend from the top and bottom of the glass surface, creating texture that breaks up the smooth surface.

2. An expansive roof garden on the third floor—designed by Christy Ten Eyck of Ten Eyck Landscape Architects—provides outdoor space for employees to eat, have meetings, and stage events. A door connects this exterior space to the mezzanine in the cafeteria, and windows look down into that double-height space.

3. Employees enter the building from a side entrance that also leads to three levels of below-grade parking. So as not to minimize the entry experience for those commuters, careful attention was paid to landscaping the site with native plant species and using light and graphics in the underground parking area to create a meaningful arrival experience.



First Floor

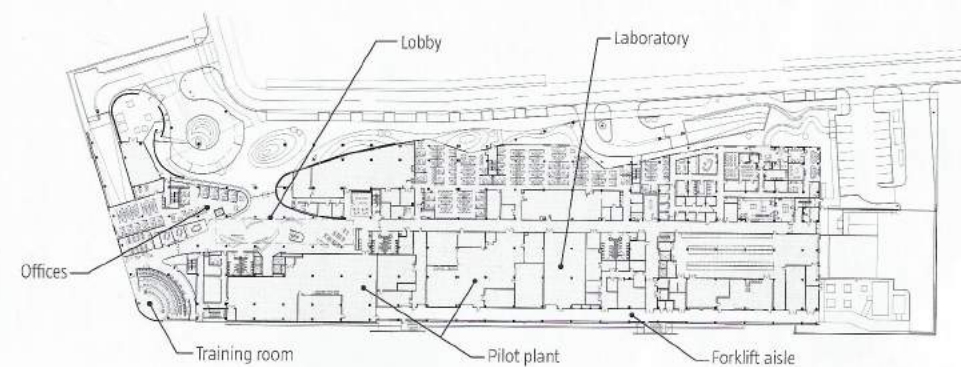

Second Floor



Third Floor

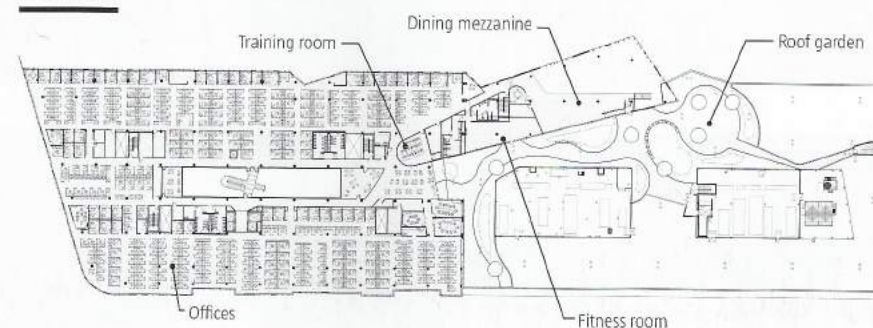

Fourth Floor

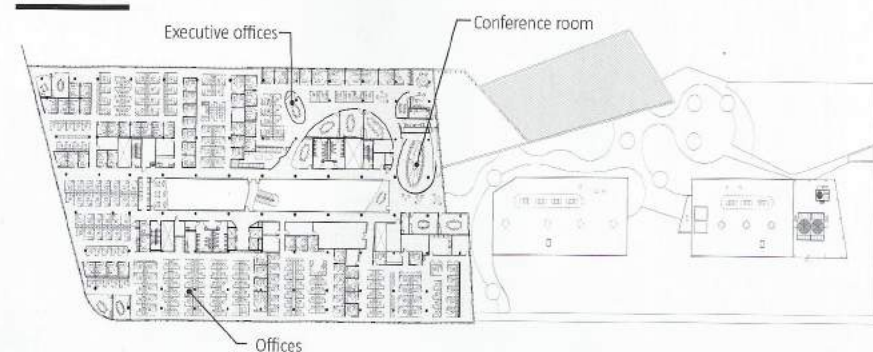

TOOLBOX

Texlon ETFE Atrium Skylight System

Vector-Foiltec
foiltec.com

The atrium, or "vessel of light," as Bruder calls it, is topped with an 18-foot-wide by 180-foot-long multicell inflated membrane skylight. A three-layer system with shade patterns on upper and middle layers, the skylight lets in a flood of natural light while minimizing solar heat gain.

Curtain Wall and Cladding Systems

KT Fabrication
phone 480.497.3140

An aluminum curtain wall system wraps the Henkel headquarters. Spandrel glass and aluminum panels vary across the façade. Bruder specified custom mullion cap profiles. Deeper than standard, the design exploits visual phenomena, so that the metal takes on color: The topside reflects the blue sky, while the underside reflects earth brown.

Fritted Glass

Viracon
viracon.com

Frit patterns appear on all of the building's exterior glazing. More than simple ornament, the custom patterns aid in daylight control. To counter heavy sun exposure, the west and south façades employ high-density fritting, while the east and north use medium-density patterning. Opaque fritting stops heat gain before it enters the cavity of the insulated glass, while translucent white fritting diffuses daylight farther into the floorplate.

Translucent Colored Fiberglass

American Fiberglass
americanfiberglass.us

Red and amber-colored translucent column jackets greet visitors on arrival to the headquarters and mark the entry to the employee cafeteria. Jewel-toned and sculptural, the column covers are composed of glass fiber-reinforced pigmented resin over custom forms.

1. A dip in the façade hidden beneath the monumental glass curtain wall holds a porte-cochere where visitors approach and enter the building out of the sun. Fairly quiet materials such as metal panels, fritted glass, and brick are offset by a brightly colored fiberglass-wrapped column and neon signs that showcase the different consumer brands that fall under the Henkel umbrella.

2. At the center of the building is an 82-foot-high atrium capped with an inflatable membrane skylight that has screen-printed translucent patterning to diffuse the harsh light of the desert sun. Windows into the surrounding offices and laboratories bring daylight into the middle of the floor plates, and an open staircase with large landings allows for both a central circulation point and a spot for spontaneous conversations.

3. The cafetorium is a mixed-use space in the building, serving as both a staff cafeteria and an auditorium where all of the employees can gather for meetings and events. A canted ceiling plane starts low at the windows and moves higher to accommodate a mezzanine that increases the capacity of the space.



Project Credits

Project Henkel Headquarters

Client Henkel North America

Architect and Interior Designer Will Bruder+Partners, Phoenix—Will Bruder, Ben Nesbitt, Ron Deitrick, Dan Olic, Marjorie Whitton, Joaquin Roesch, Fernando Da Col, Anthony Yozipovic, Anthony Tumminello, Dominique Price, Chris Balzano, Claudia Saunders (project team)

Architect CH2M Hill, Tempe, Ariz.—Steve Waite, Tim Allen, Thane Joyce, Ed Hemrick (project team)

Structural Engineer Paragon Structural Design

Mechanical and Electrical Engineer CH2M Hill

Landscape Architect Ten Eyck Landscape Architects

Lighting Design Francis Krahe Associates

Acoustical Consulting Tony Sola
Size 348,000 square feet

